

WARNING
BEWARE OF UNDERGROUND SERVICES
THE LOCATIONS OF UNDERGROUND SERVICES SHOWN ARE APPROXIMATE ONLY AND THEIR EXACT POSITION SHOULD BE PROVEN ON SITE.

Copyright of this drawing is vested in Cardno Grogan Richards and the drawing shall not be reproduced or copied in whole or in part, in any form, without the written approval of Cardno Grogan Richards.

| | | | | |
|-----|----------|--------------------------|-----|-----|
| P16 | 03.11.10 | UPDATED BASE PLAN | DM | JPM |
| P9 | 08.10.10 | CLIENT COMMENTS | DM | JPM |
| P8 | 05.10.10 | GENERAL AMENDMENTS | DM | JPM |
| P7 | 04.06.10 | LOADING BAY MODIFICATION | DM | CM |
| P4 | 06.05.10 | GENERAL AMENDMENTS | JCS | CM |
| P5 | 10.02.10 | CLIENT COMMENTS | JCS | JPM |
| P6 | 09.02.10 | COUNCIL COMMENTS | JCS | JPM |
| P3 | 08.09.09 | GENERAL AMENDMENTS | JCS | JPM |
| P2 | 21.08.09 | CLIENT COMMENTS | DM | JPM |
| P1 | 20.08.09 | ISSUED FOR INFORMATION | DM | JPM |

Issue: Date: Description: By: Approved:

Cardno Grogan Richards
Consulting Engineers
Structural, Civil, Hydraulic, Land Surveying, Traffic & Transportation
Cardno Victoria Pty Ltd ABN 47 106 610 913
150 Oxford Street Collingwood, VIC 3066
Tel: 03 8415 7777 Fax: 03 8415 7788
cardno@cardno.com.au www.cardno.com.au

| | | | |
|--|--|------------|----------------------------|
| Client: | McMULLIN GROUP PTY LTD | | |
| Project Name: | MAYFIELD PLACE | | |
| Location: | MAYFIELD (NEWCASTLE) | | |
| | NSW | Met. Ref | |
| Title: | PROPOSED FUNCTIONAL LAYOUT OPTION 4 | | |
| Designer: | DM | Drawn: | DM |
| Checked: | JPM | 20/08/2009 | Authorised: |
| Scale: | 1:500 | A1 | Job: CG109171 / T / 06 P14 |
| PRELIMINARY NOT TO BE USED FOR CONSTRUCTION PURPOSES | | | |

- GENERAL NOTES**
1. BASE INFORMATION SUPPLIED BY PARKER SCANLON PTY. REF No. B131-DET-D
 2. ALL DIMENSIONS TO FACE OF KERB AND CHANNEL U.N.O
 3. DECLARED ROAD - MAITLAND ROAD (60KM/H)
 4. LOCAL ROAD - CHURCH & NILE STREET (50KM/H)
 5. ALL REDUNDANT DRIVEWAYS ON MAITLAND ROAD TO BE REINSTATED AS KERB AND RESTRICTED TO LEFT IN / LEFT OUT ONLY.
 6. STREET LIGHTING TO BE UPGRADED IN ACCORDANCE WITH RELEVANT AUSTRALIAN STANDARDS AND TO RTA AND COUNCIL REQUIREMENTS DURING DETAILED DESIGN.
 7. CONSTRUCTION MANAGEMENT PLANS TO BE PREPARED AND SUBMITTED FOR REVIEW AND APPROVAL PRIOR TO ANY CONSTRUCTION ACTIVITIES COMMENCING ONSITE.
 8. ALL WORKS IS TO BE COMPLETED AT FULL COST TO THE DEVELOPER AND AT NO COST TO RTA OR COUNCIL.
 9. ALL WORKS SHALL BE DESIGNED AND CONSTRUCTED TO RTA AND COUNCIL SATISFACTION.

SIGN SCHEDULE



#2
R1-2



#16
R2-14(L)



#17



#18

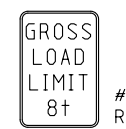

#19
R6-4



#20



#21
R5-35(L)

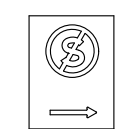

#22
R5-35(R)

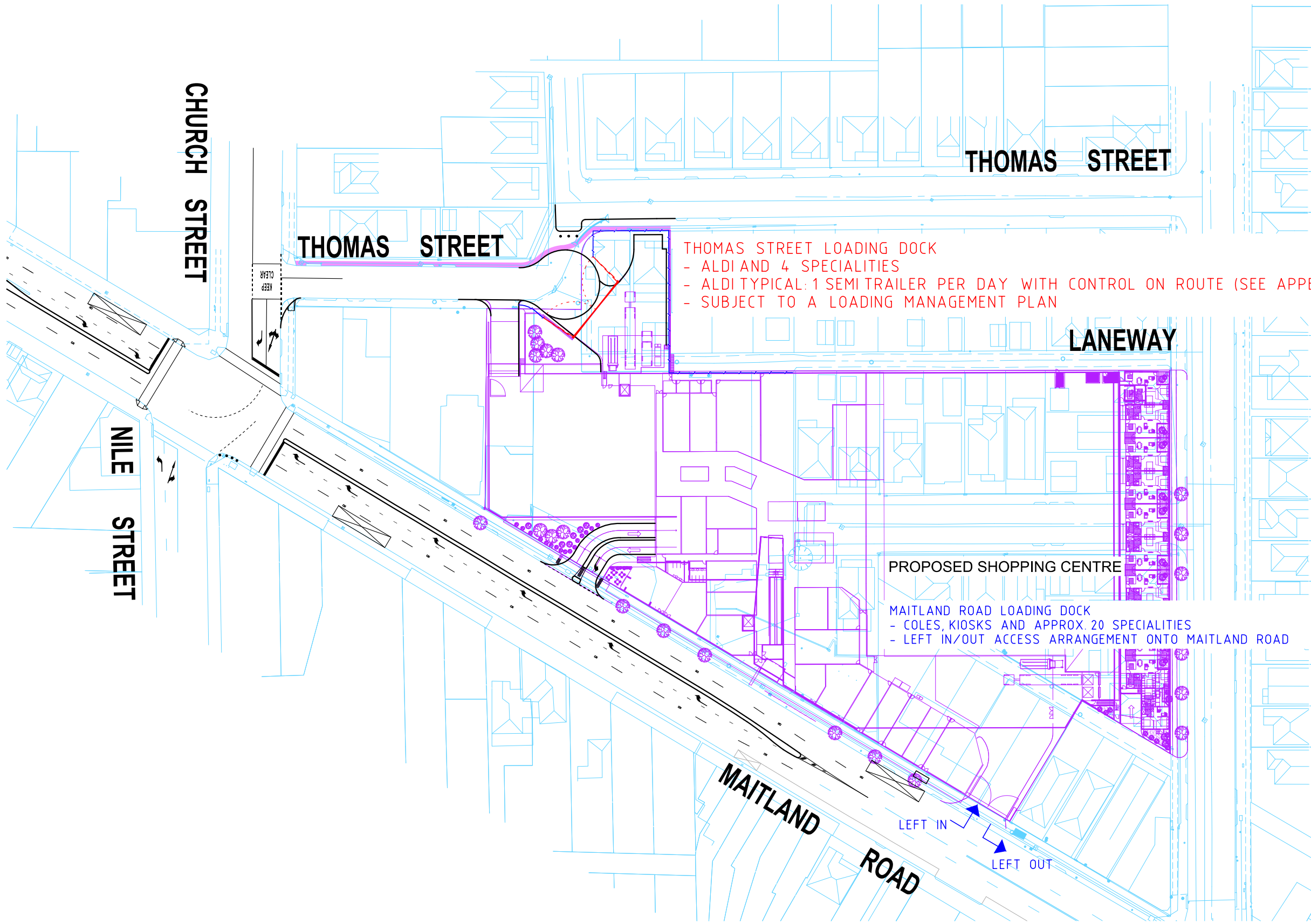

THOMAS STREET

THOMAS STREET

CHURCH STREET

NILE STREET

THOMAS STREET LOADING DOCK
- ALDI AND 4 SPECIALITIES
- ALDI TYPICAL: 1 SEMI TRAILER PER DAY WITH CONTROL ON ROUTE (SEE APPENDIX)
- SUBJECT TO A LOADING MANAGEMENT PLAN

LANEWAY

PROPOSED SHOPPING CENTRE

MAITLAND ROAD LOADING DOCK
- COLES, KIOSKS AND APPROX. 20 SPECIALITIES
- LEFT IN/OUT ACCESS ARRANGEMENT ONTO MAITLAND ROAD

MAITLAND ROAD

LEFT IN

LEFT OUT

WARNING
BEWARE OF UNDERGROUND SERVICES
THE LOCATIONS OF UNDERGROUND SERVICES SHOWN ARE APPROXIMATE ONLY AND THEIR EXACT POSITION SHOULD BE PROVEN ON SITE.

Copyright of this drawing is vested in Cardno Grogan Richards and the drawing shall not be reproduced or copied in whole or in part, in any form, without the written approval of Cardno Grogan Richards.

| | | | | | |
|--------|----------|------------------------|-----|-----------|--|
| | | | | | |
| | | | | | |
| | | | | | |
| | | | | | |
| P3 | 03.11.10 | UPDATED BASE PLAN | DM | JPM | |
| P2 | 15.10.10 | RTA COMMENTS | DM | JPM | |
| P1 | 08.10.10 | ISSUED FOR INFORMATION | DM | JPM | |
| Issue: | Date: | Description: | By: | Approved: | |

Cardno Grogan Richards
Consulting Engineers
Structural, Civil, Hydraulic, Land Surveying, Traffic & Transportation
Cardno Victoria Pty Ltd ABN 47 106 610 913
150 Oxford Street Collingwood, VIC 3068
Tel: 03 8415 7777 Fax: 03 8415 7788
cardno@cardno.com.au www.cardno.com.au

| | | | |
|--|----------|--|----|
| Client: | | McMULLIN GROUP PTY LTD | |
| Project Name: | | MAYFIELD PLACE | |
| Location: | | MAYFIELD (NEWCASTLE) NSW | |
| Title: | | COMMERCIAL ACCESS STRATEGY MAYFIELD PLACE | |
| Designer: | DM | Drawn: | DM |
| Checked: | JPM | Authorised: | |
| Scale: | 1:500 | Size: | A1 |
| Drawing Number: | CG109171 | Job: | T |
| Issue: | P3 | Deph: | 07 |
| Date: 20-08-09 | | | |
| PRELIMINARY NOT TO BE USED FOR CONSTRUCTION PURPOSES | | | |

GENERAL NOTES

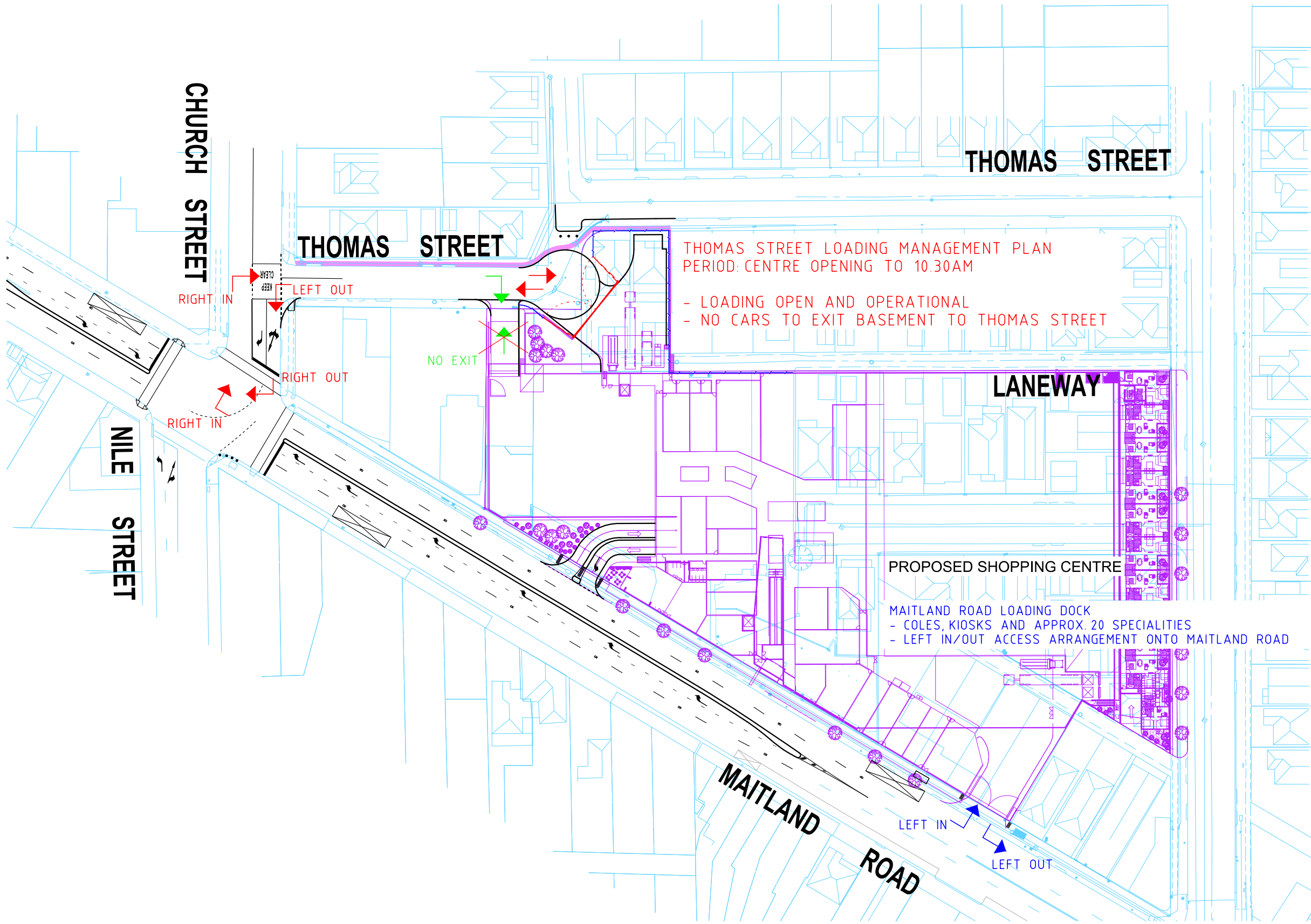

THOMAS STREET LOADING MANAGEMENT PLAN
PERIOD: CENTRE OPENING TO 10.30AM

- LOADING OPEN AND OPERATIONAL
- NO CARS TO EXIT BASEMENT TO THOMAS STREET

PROPOSED SHOPPING CENTRE

- COLES, KIOSKS AND APPROX. 20 SPECIALITIES
- LEFT IN/OUT ACCESS ARRANGEMENT ONTO MAITLAND ROAD

WARNING
BEWARE OF UNDERGROUND SERVICES
THE LOCATIONS OF UNDERGROUND SERVICES SHOWN ARE APPROXIMATE ONLY AND THEIR EXACT POSITION SHOULD BE PROVEN ON SITE.

Copyright of this drawing is vested in Cardno Grogan Richards and the drawing shall not be reproduced or copied in whole or in part, in any form, without the written approval of Cardno Grogan Richards.

| | | | | |
|--------|----------|------------------------|--------------|---------------|
| P3 | 03.11.10 | UPDATED BASE PLAN | DM | JPM |
| P2 | 15.10.10 | RTA COMMENTS | DM | JPM |
| P1 | 08.10.10 | ISSUED FOR INFORMATION | DM | JPM |
| Issue: | | Date: | Description: | By: Approved: |

Cardno Grogan Richards
Consulting Engineers
Structural, Civil, Hydraulic, Land Surveying, Traffic & Transportation
Cardno Victoria Pty Ltd ABN 47 106 610 913
150 Oxford Street Collingwood, VIC 3068
Tel: 03 8415 7777 Fax: 03 8415 7788
cardno@cardno.com.au www.cardno.com.au

| | | | |
|--|----------|---|----|
| Client: | | McMULLIN GROUP PTY LTD | |
| Project Name: | | MAYFIELD PLACE | |
| Location: | | MAYFIELD (NEWCASTLE) NSW | |
| Title: | | COMMERCIAL ACCESS STRATEGY THOMAS STREET LOADING MANAGEMENT PLAN | |
| Designer: | DM | Drawn: | DM |
| Checked: | JPM | Authorised: | |
| Scale: | 1:500 | Size: | A1 |
| Drawing Number: | CG109171 | Job: | T |
| Issue: | P3 | Deph: | 08 |
| Date: 20-08-09 | | | |
| PRELIMINARY NOT TO BE USED FOR CONSTRUCTION PURPOSES | | | |

GENERAL NOTES

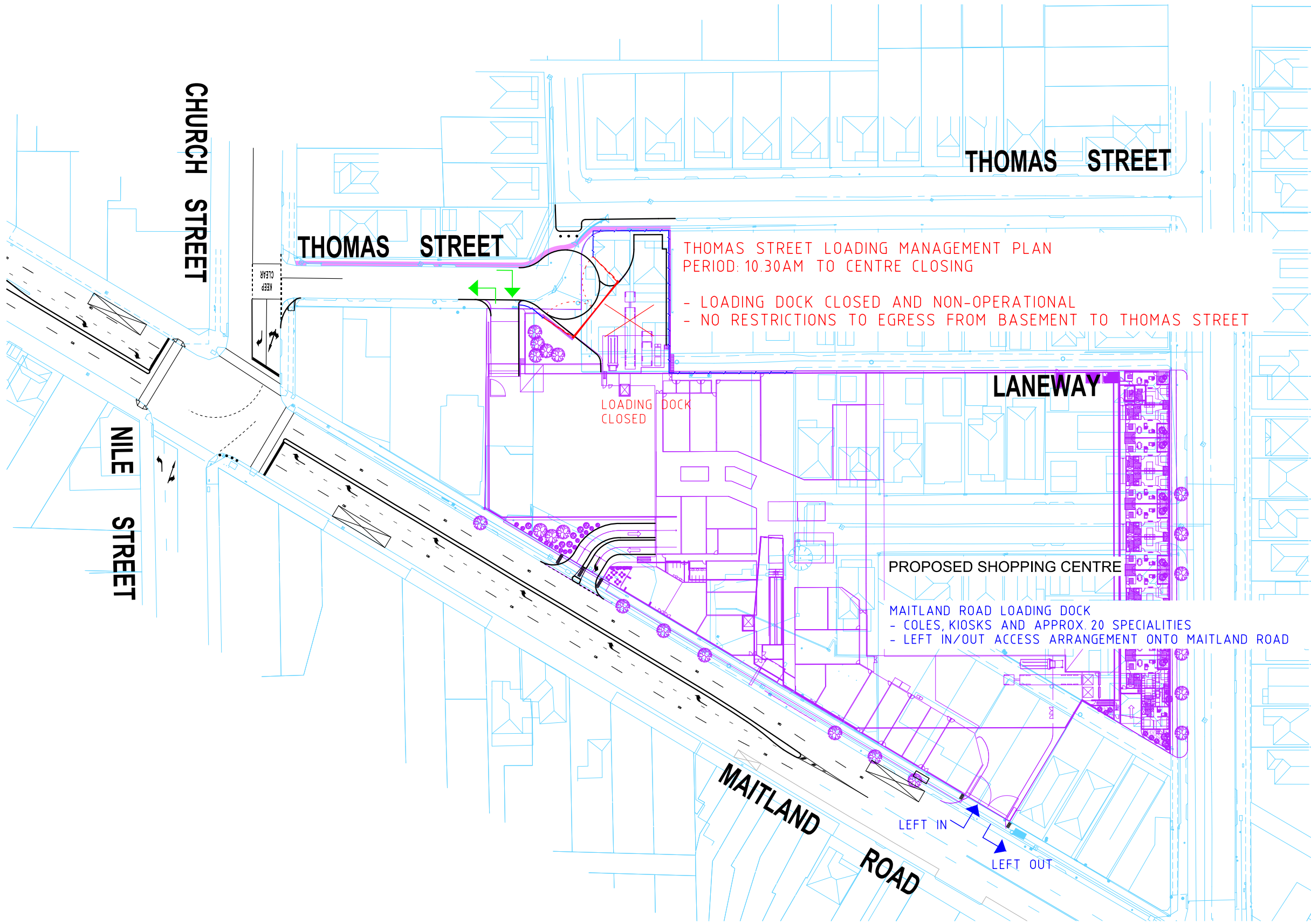

THOMAS STREET

THOMAS STREET

CHURCH STREET

NILE STREET

THOMAS STREET LOADING MANAGEMENT PLAN
PERIOD: 10.30AM TO CENTRE CLOSING

- LOADING DOCK CLOSED AND NON-OPERATIONAL
- NO RESTRICTIONS TO EGRESS FROM BASEMENT TO THOMAS STREET

LOADING DOCK
CLOSED

LANEWAY

PROPOSED SHOPPING CENTRE

MAITLAND ROAD LOADING DOCK
- COLES, KIOSKS AND APPROX. 20 SPECIALITIES
- LEFT IN/OUT ACCESS ARRANGEMENT ONTO MAITLAND ROAD

MAITLAND ROAD

LEFT IN

LEFT OUT

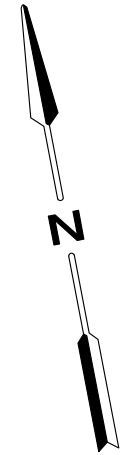

WARNING
BEWARE OF UNDERGROUND SERVICES
THE LOCATIONS OF UNDERGROUND SERVICES
SHOWN ARE APPROXIMATE ONLY AND THEIR
EXACT POSITION SHOULD BE PROVEN ON SITE.

Copyright of this drawing is vested in Cardno Grogan Richards and the drawing shall not be reproduced or copied in whole or in part, in any form, without the written approval of Cardno Grogan Richards.

| | | | | | |
|--------|----------|------------------------|-----|-----------|--|
| | | | | | |
| | | | | | |
| | | | | | |
| | | | | | |
| P3 | 03.11.10 | UPDATED BASE PLAN | DM | JPM | |
| P2 | 15.10.10 | RTA COMMENTS | DM | JPM | |
| P1 | 08.10.10 | ISSUED FOR INFORMATION | DM | JPM | |
| Issue: | Date: | Description: | By: | Approved: | |

Cardno Grogan Richards
Consulting Engineers
Structural, Civil, Hydraulic, Land Surveying, Traffic & Transportation
Cardno Victoria Pty Ltd ABN 47 106 610 913
150 Oxford Street Collingwood, VIC 3066
Tel: 03 8415 7777 Fax: 03 8415 7788
cardno@cardno.com.au www.cardno.com.au

| | | | |
|--|----------|---|----|
| Client: | | McMULLIN GROUP PTY LTD | |
| Project Name: | | MAYFIELD PLACE | |
| Location: | | MAYFIELD (NEWCASTLE) NSW | |
| Title: | | COMMERCIAL ACCESS STRATEGY THOMAS STREET LOADING MANAGEMENT PLAN | |
| Designer: | DM | Drawn: | DM |
| Checked: | JPM | Authorised: | |
| Scale: | 1:500 | Size: | A1 |
| Drawing Number: | CG109171 | Job: | T |
| Issue: | P3 | Deph: | 09 |
| PRELIMINARY NOT TO BE USED FOR CONSTRUCTION PURPOSES | | | |

GENERAL NOTES

DATE PLOTTED: 03/11/2010 2:27:22 PM

CAD FILE: D:\TRAFF\2009\CG109171\Drawings\CG109171-T10.dgn

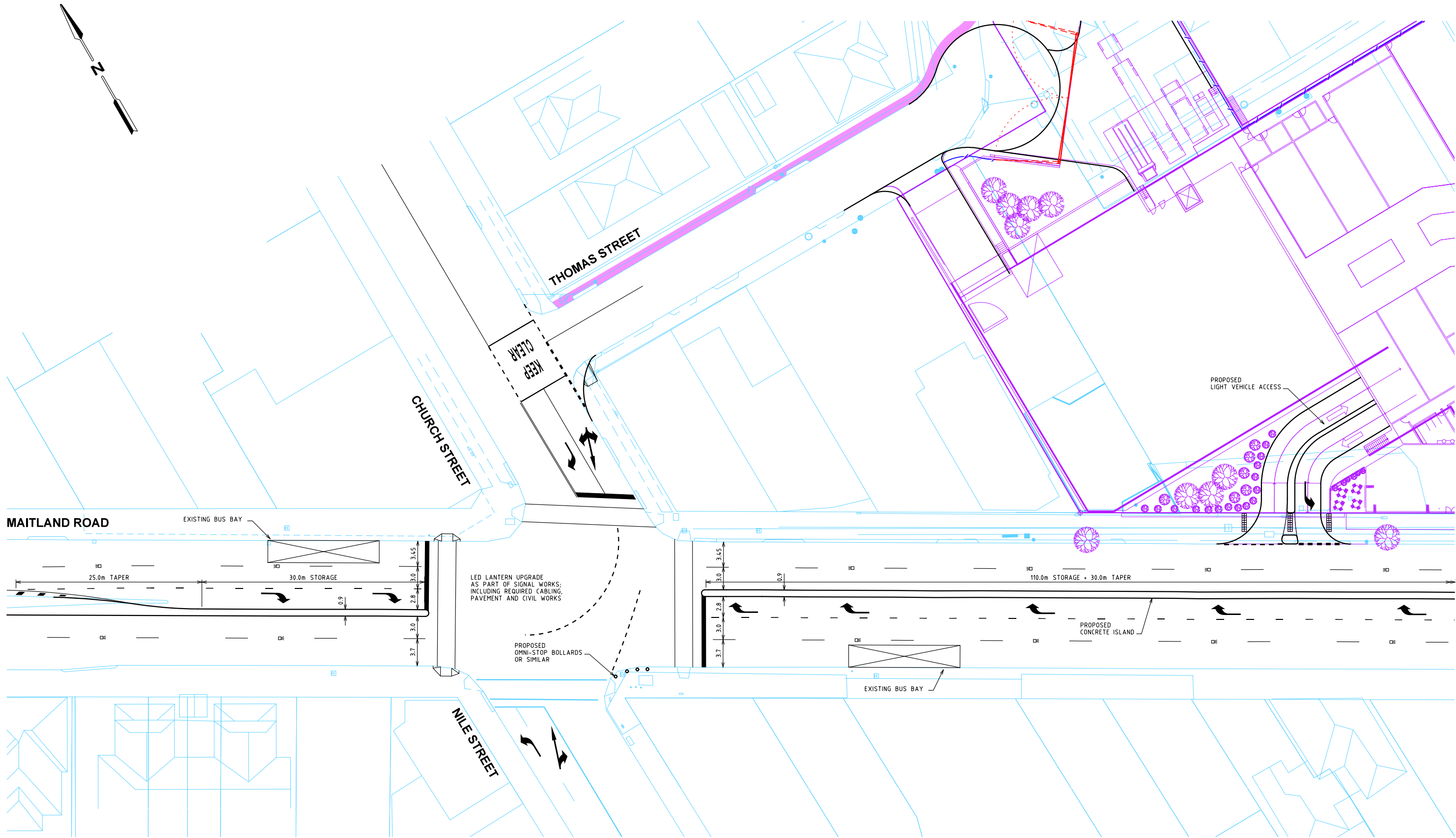

| Rev | Date | Description | Drawn | Appr. |
|-----|----------|------------------------|-------|-------|
| P3 | 03.11.10 | UPDATED BASE PLAN | DM | JPM |
| P2 | 28.10.10 | GENERAL AMENDMENTS | DM | JPM |
| P1 | 15.10.10 | ISSUED FOR INFORMATION | DM | JPM |

© Cardno Victoria Pty Ltd All Rights Reserved.
This document is produced by Cardno Victoria Pty Ltd solely for the benefit of and use by the client in accordance with the terms of the retainer. Cardno Victoria Pty Ltd does not and shall not assume any responsibility or liability whatsoever to any third party arising out of any use or reliance by third party on the content of this document.

WARNING
BEWARE OF UNDERGROUND SERVICES
THE LOCATIONS OF UNDERGROUND SERVICES SHOWN ARE APPROXIMATE ONLY AND THEIR EXACT POSITION SHOULD BE PROVEN ON SITE.

SCALE: 1:250 A1

Cardno
Grogan Richards
Consulting Engineers
Structural, Civil, Hydraulic, Land Surveying, Traffic & Transportation
Cardno Victoria Pty Ltd ABN 47 106 610 913
150 Oxford Street Collingwood, VIC 3066
Tel: +61 3 9415 7777 Fax: +61 3 9415 7788
cgr@cardno.com.au www.cardnogroganrichards.com.au

| | |
|----------|-----|
| Drawn | DM |
| Designed | DM |
| Checked | JPM |
| Reviewed | JPM |
| Approved | JPM |

Client: **McMULLIN GROUP PTY LTD**
Project: **MAYFIELD PLACE
MAYFIELD (NEWCASTLE)
NSW**
Title: **PROPOSED FUNCTIONAL LAYOUT
MAITLAND RD / CHURCH ST / NILE ST**

| | | | |
|--|--------------------|----------|-------|
| Status | PRELIMINARY | | |
| NOT TO BE USED FOR CONSTRUCTION PURPOSES | | | |
| Date | 15.10.2010 | Datum | |
| Scale | 1:250 | Size | A1 |
| Drawing Number | CG109171 | Revision | 10 P3 |

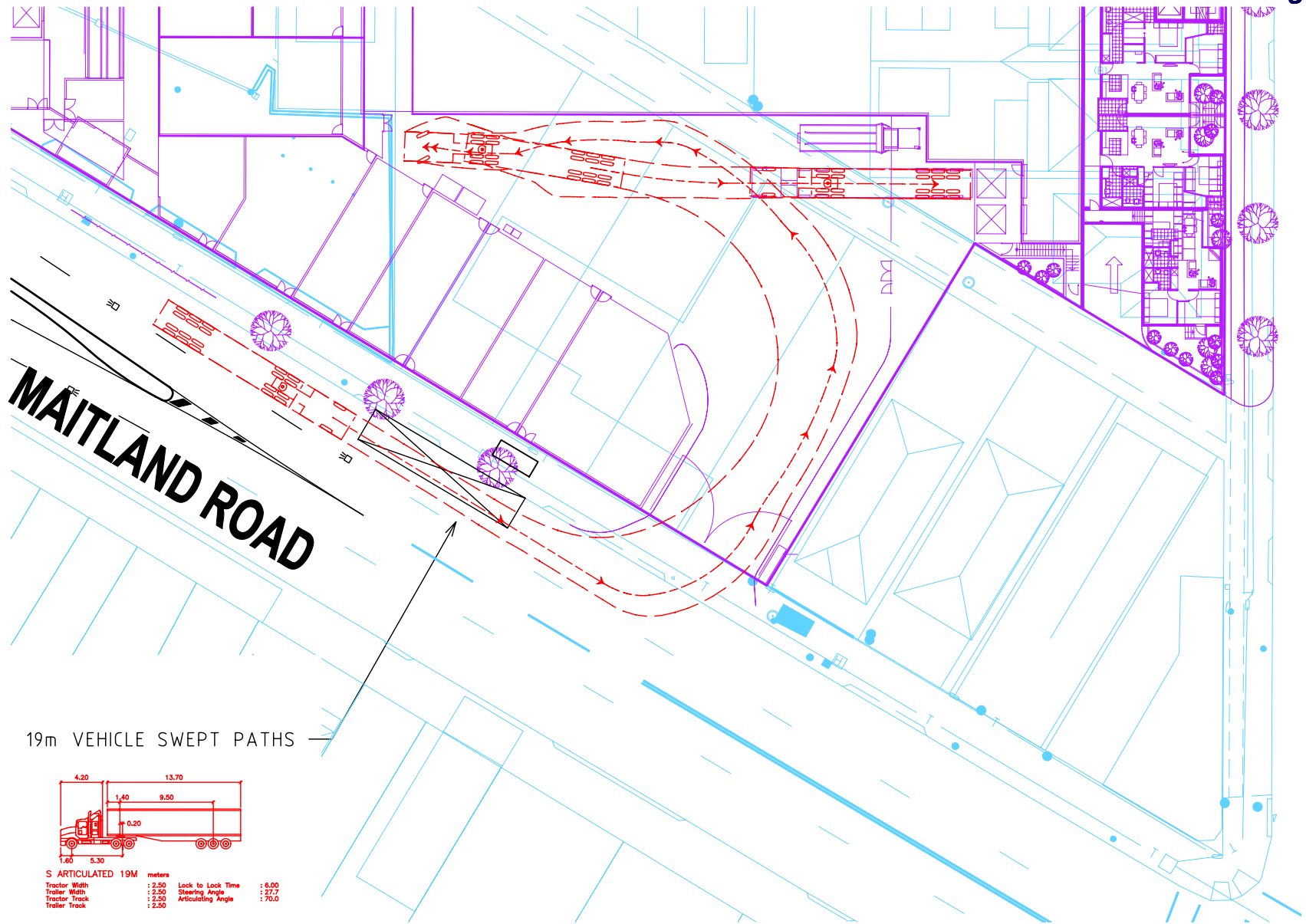

INGRESS

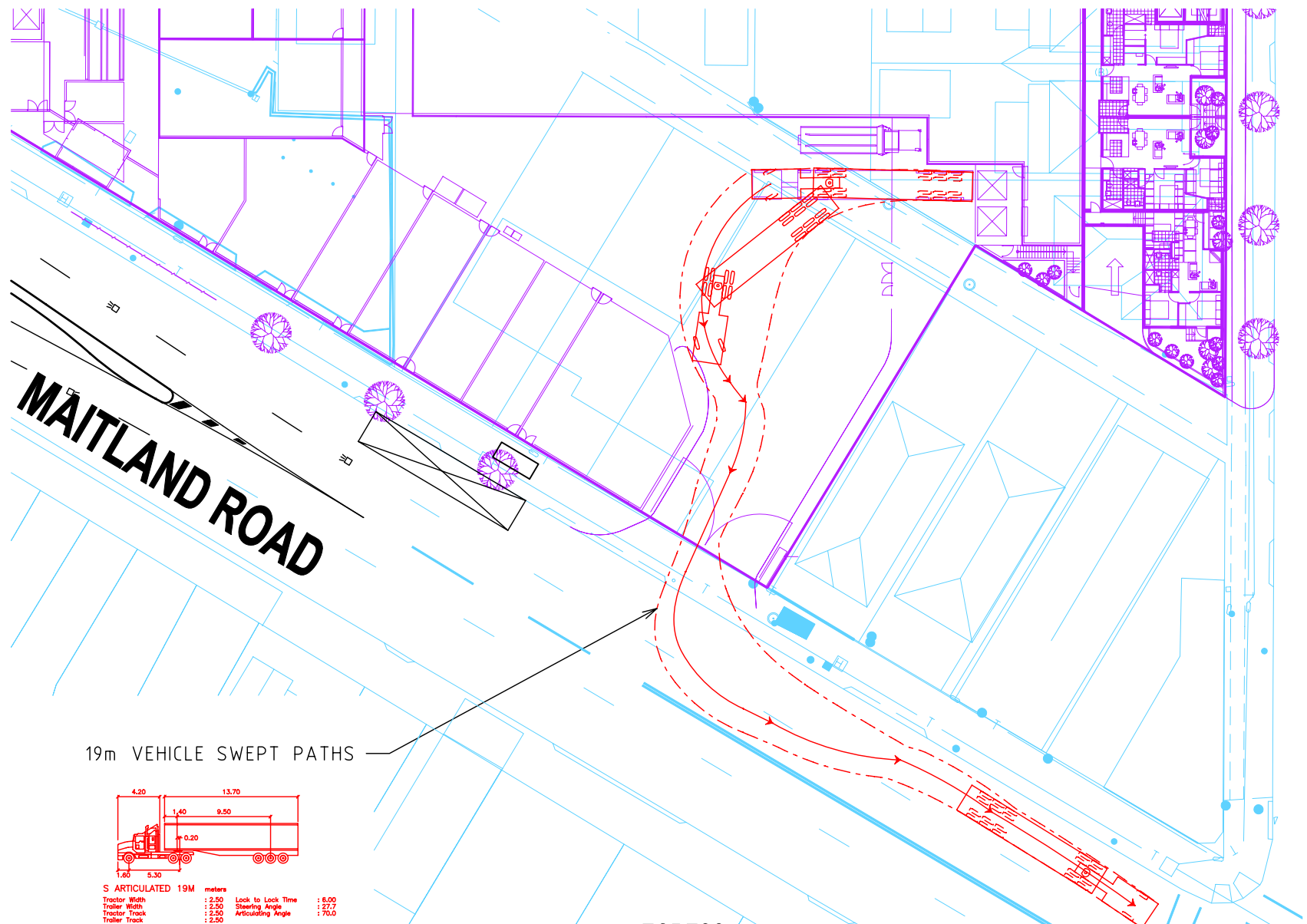

EGRESS

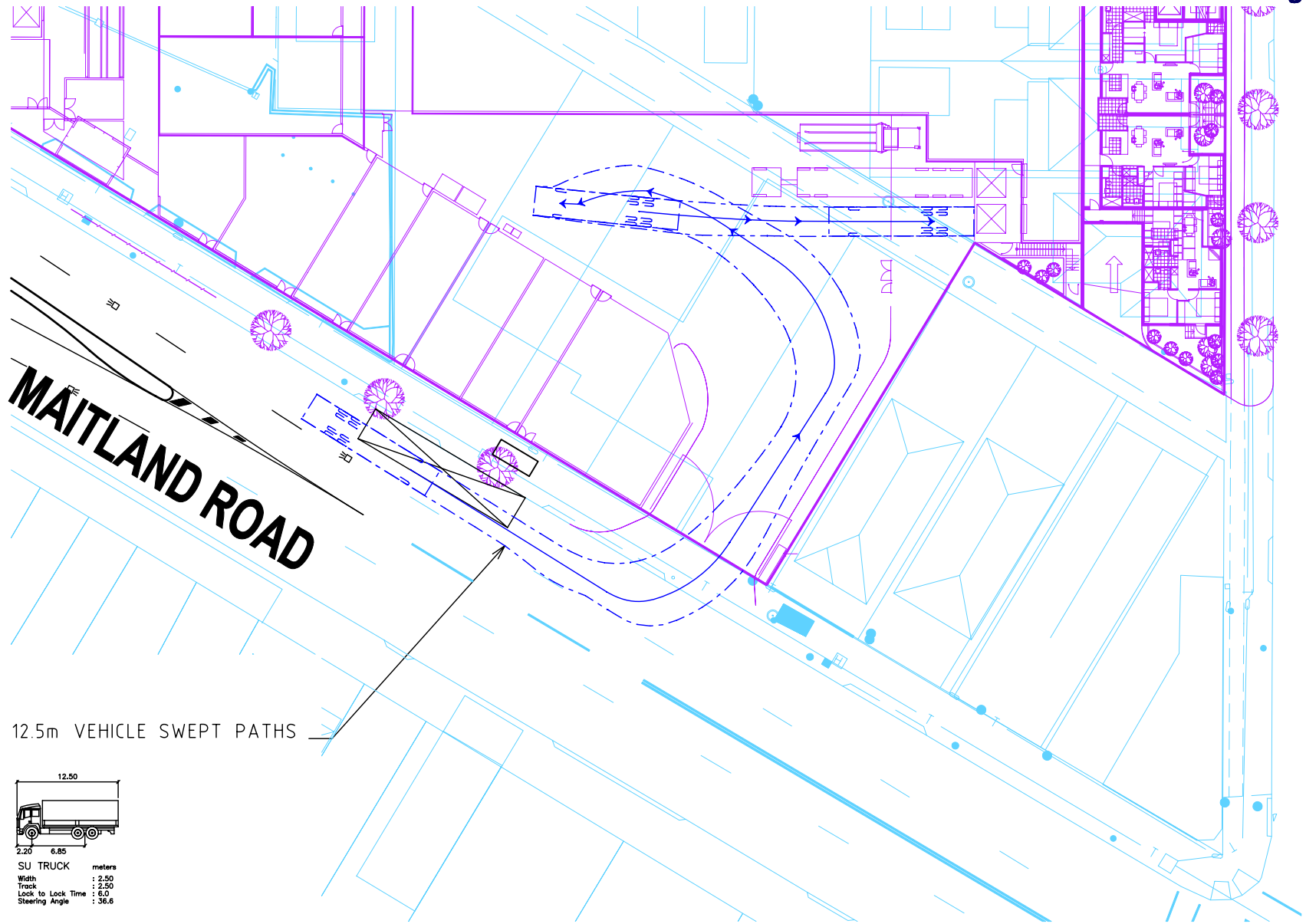

INGRESS

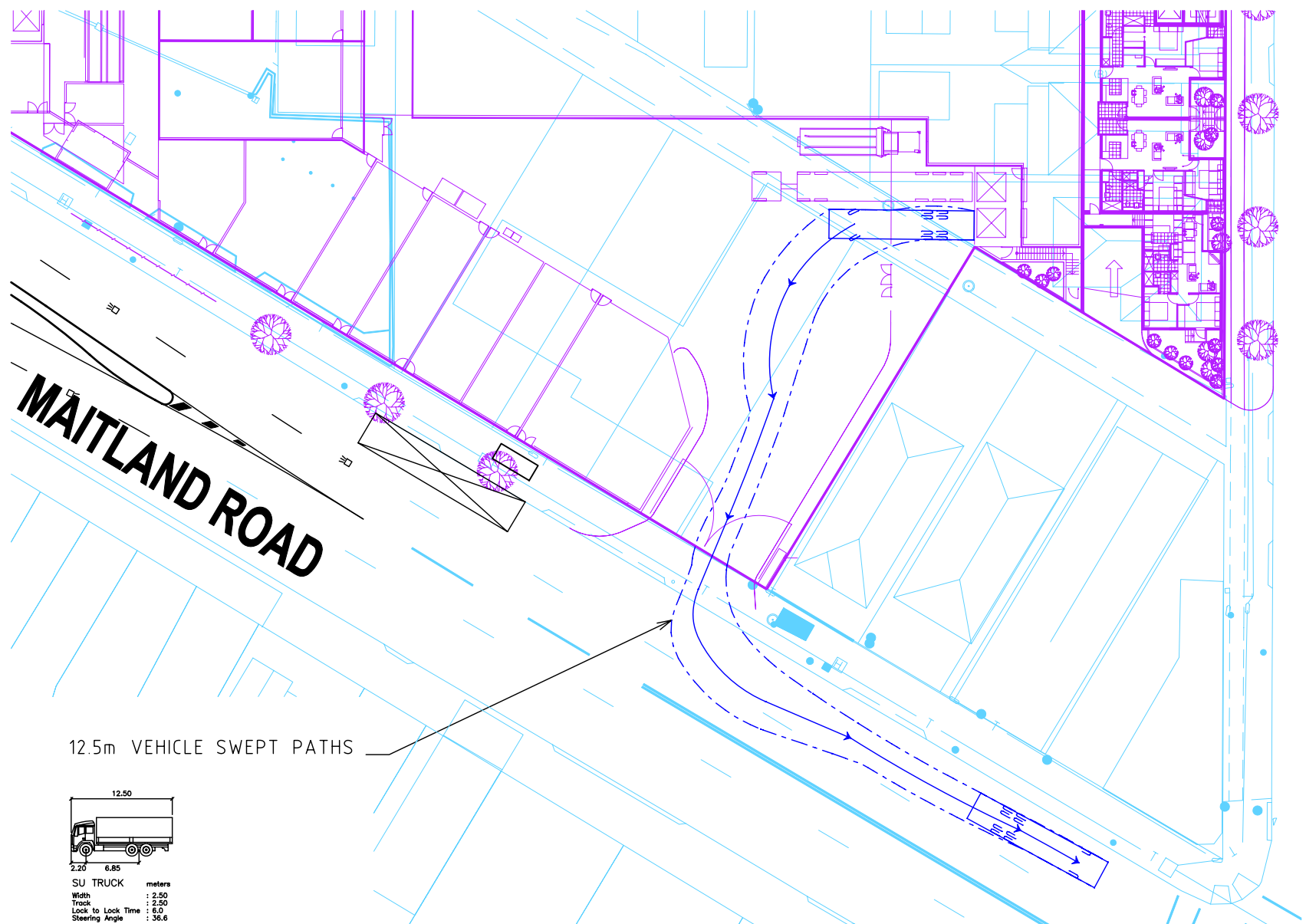

EGRESS

COLES LOADING DOCK - MAYFIELD PLACE (NEWCASTLE) - NSW
12.5m VEHICLE SWEPT PATH ANALYSIS

SCALE - 1:500@A3 DATE - 15.11.2010

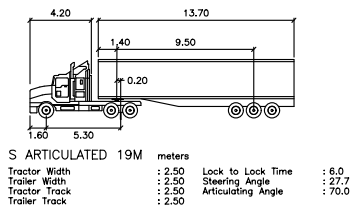

CG109171SK16 - MAYFIELD PLACE, NEWCASTLE (NSW)
19m VEHICLE SWEEP PATH ANALYSIS (0.6m CLEARANCE AS SHOWN)
SCALE - 1:250 @ A3 DATE - 03-11-2010

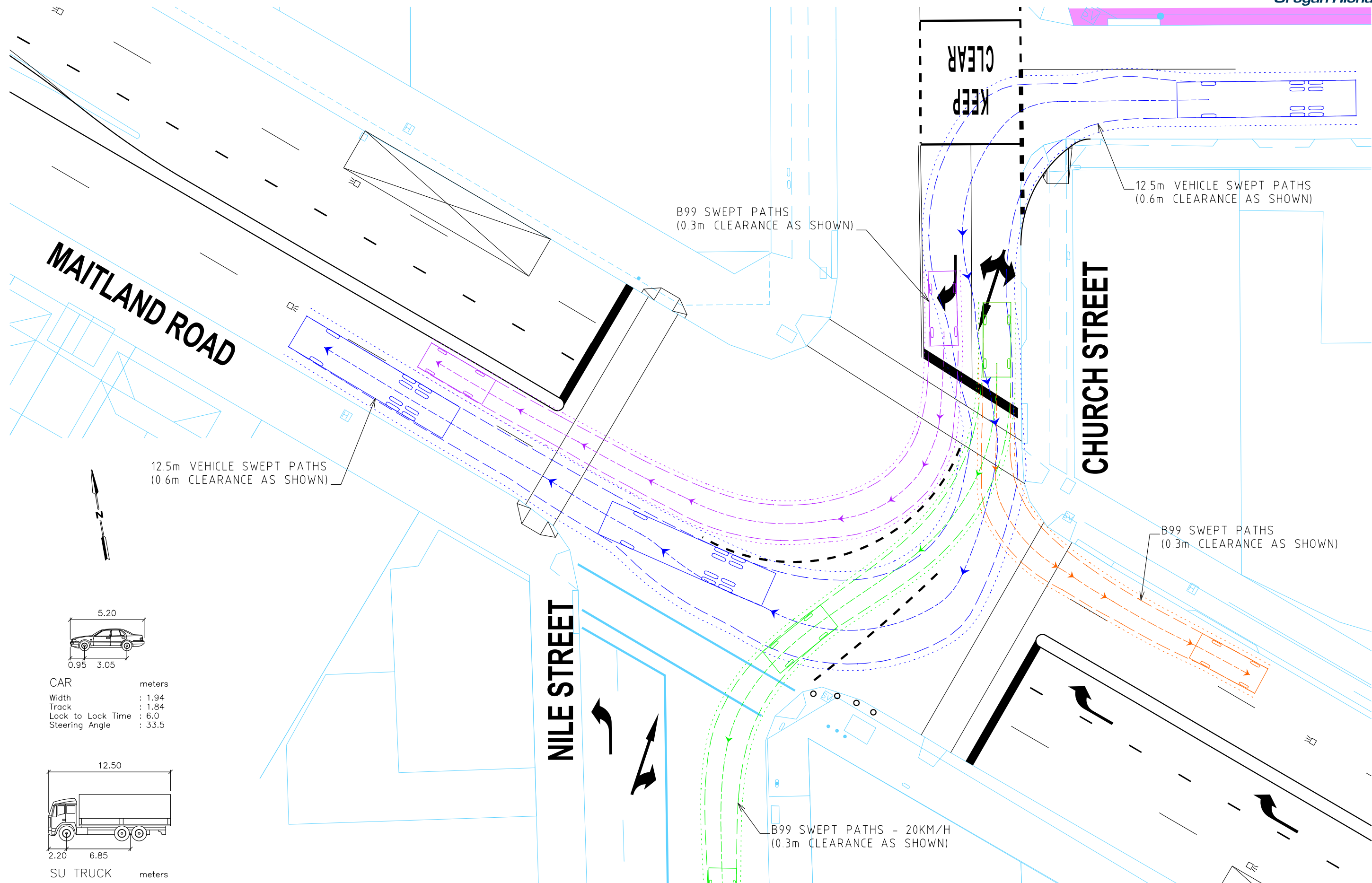

CG109171SK17 - MAYFIELD PLACE, NEWCASTLE (NSW)
SWEPT PATH ANALYSIS (CLEARANCE AS SHOWN)

SCALE - 1:250 @ A3 DATE - 03-11-2010

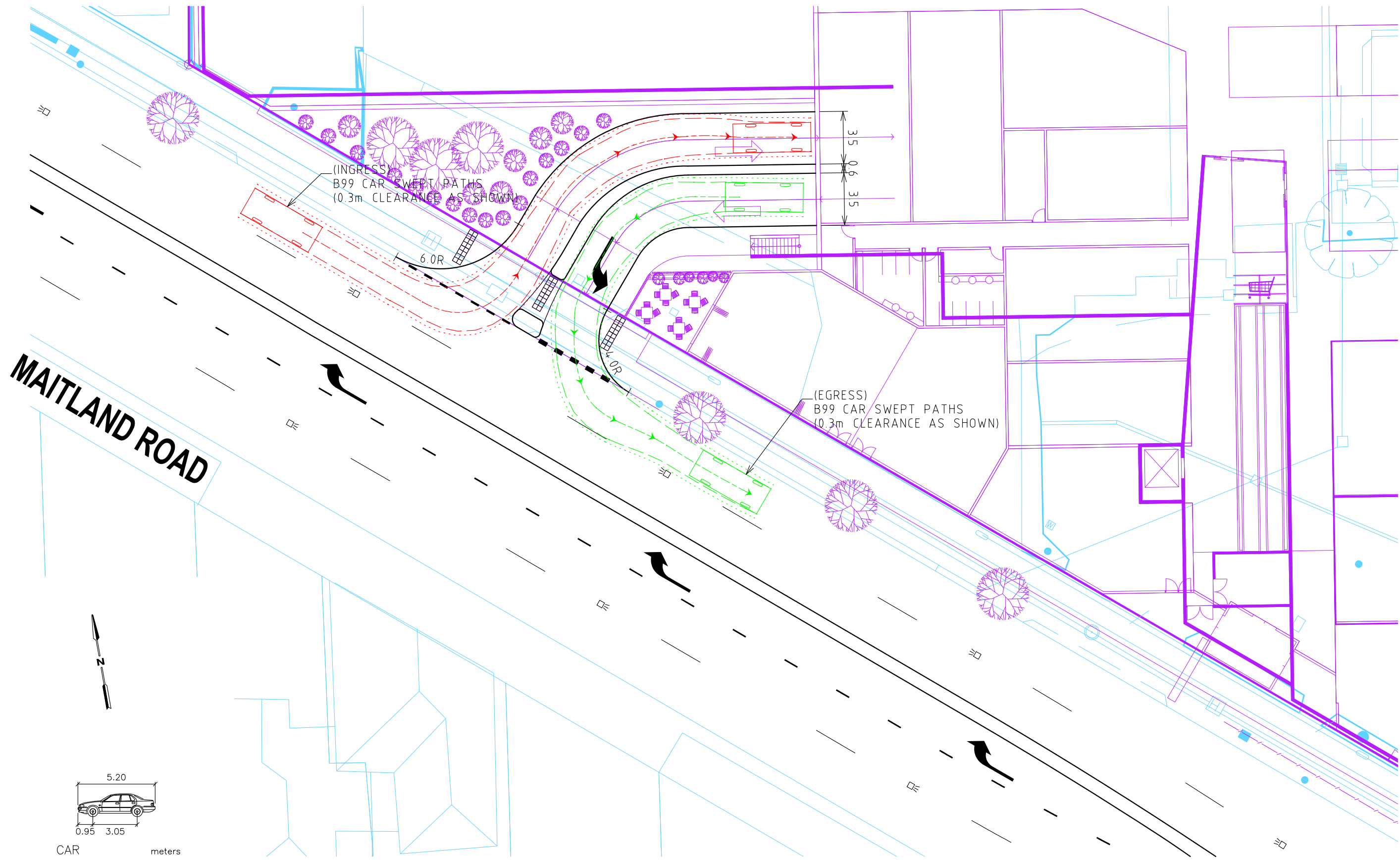

CG109171SK18 - MAYFIELD PLACE, NEWCASTLE (NSW)
B99 CAR SWEEP PATH ANALYSIS (0.3m CLEARANCE AS SHOWN)

SCALE - 1:250 @ A3 DATE - 03-11-2010

THOMAS STREET

12.5m VEHICLE SWEPT PATHS
(0.6m CLEARANCE AS SHOWN)

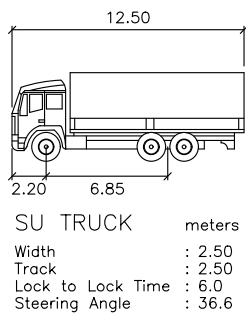

CG109171SK19 - MAYFIELD PLACE, NEWCASTLE (NSW)
12.5m VEHICLE SWEPT PATH ANALYSIS (0.6m CLEARANCE AS SHOWN)

SCALE - 1:250 @ A3 DATE - 03-11-2010

THOMAS STREET

19.0m VEHICLE SWEPT
PATH ANALYSIS

PROPOSED NEW
COMPACTOR LOCATION

CG109171SK20 - MAYFIELD PLACE, NEWCASTLE (NSW)
19.0m VEHICLE SWEPT PATH ANALYSIS

SCALE - 1:250 @ A3 DATE - 15.11.2010

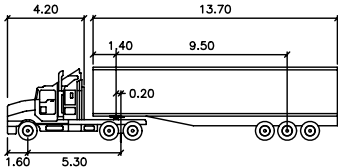

| | |
|--------------------|--------|
| S ARTICULATED 19M | meters |
| Tractor Width | : 4.20 |
| Tractor Track | : 1.40 |
| Trailer Width | : 9.50 |
| Trailer Track | : 0.20 |
| Tractor Overhang | : 1.60 |
| Tractor Wheelbase | : 5.30 |
| Lock to Lock Time | : 6.0 |
| Steering Angle | : 27.7 |
| Articulating Angle | : 70.0 |

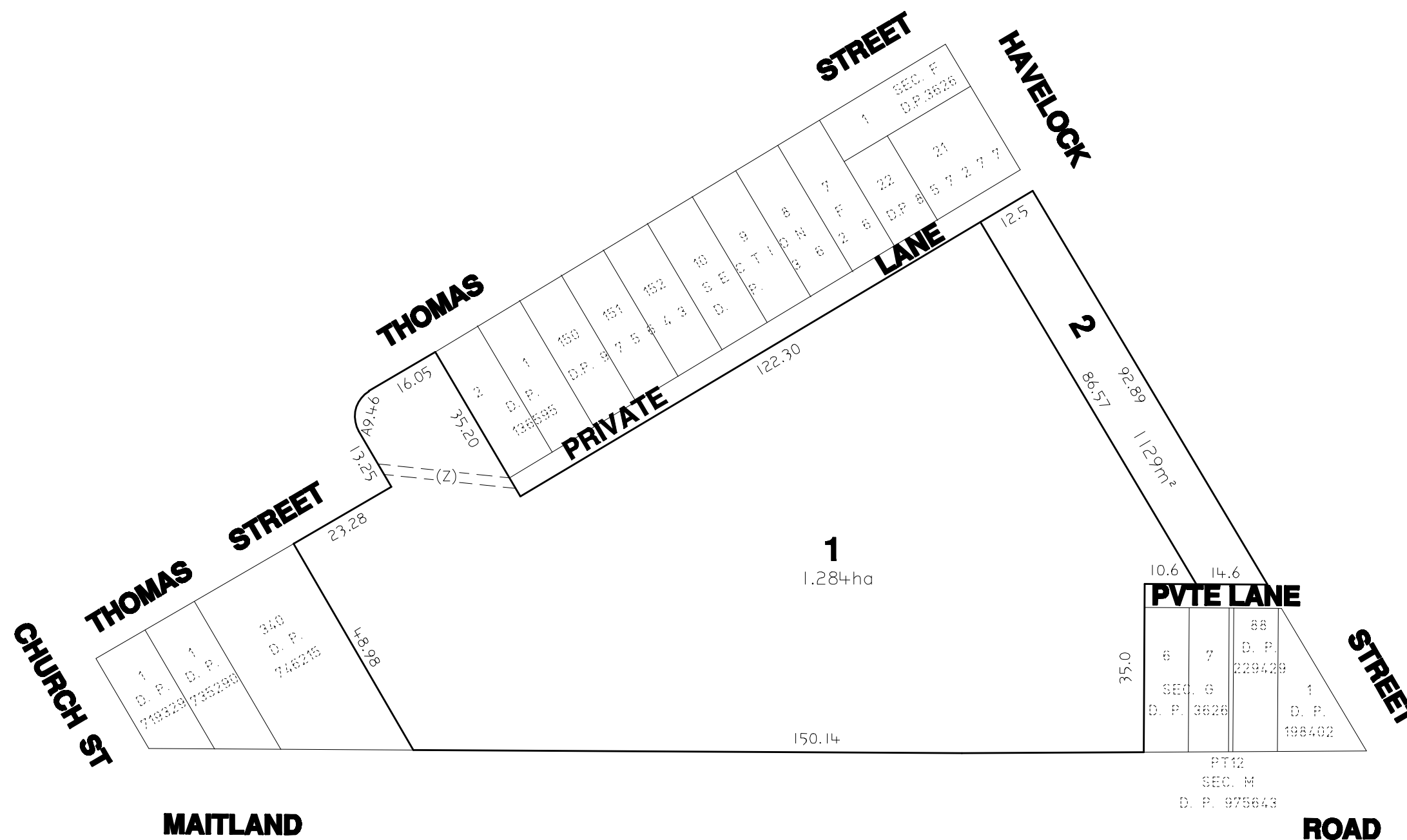
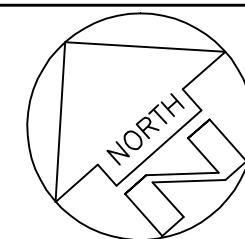

MAITLAND

ROAD

NOTE:
ALL DIMENSIONS, AREAS, EASEMENTS AND LOT
CONFIGURATIONS ARE APPROXIMATE AND SUBJECT TO
FINAL PLAN OF SURVEY.

(Z) EASEMENT TO DRAIN WATER AND FOR OVERLAND FLOW 2.0 WIDE.



Surveying, Engineering, Town Planning and Project Management

Level 1/68 Belford Street BROADMEADOW • PO Box 187 BROADMEADOW NSW 2292
Ph: 4969 6995 • Fax: 4969 6997 • Email: surveys@parkerscanlon.com.au • ABN 36124 624 022
www.parkerscanlon.com.au

TITLE:
PLAN OF PROPOSED SUBDIVISION OF LOT 5
D.P.625925, LOT 10 D.P.1010126, LOT 1
D.P.197017, LOTS 1-5 SECTION G D.P.3626,
LOT 1 D.P.783265, LOTS 164-165 & 173-177
SECTION L D.P.975643, LOT 3 D.P.161861, LOT
4-6 & 11-14 SECTION F D.P.3626, LOTS 1-2
D.P.37351, HEWSON STREET AND PART PRIVATE
LANES AT MAYFIELD

| | | | |
|-----------------|---------------------|-----------------|---------|
| DATE: | 16 July 2009 | | |
| DRAWING: | L:\B131\B131-TENT-B | | |
| DRAWN/SURVEYED: | SJB/ | | |
| SCALE (A3): | 1:1000 | DATUM: | ASSUMED |
| REFERENCE No: | B131 | SHEET OF SHEETS | 1 1 |

MAYFIELD PLACE - TOWN PLANNING DRAWINGS

SUBMITTED TO COUNCIL ON 15 NOVEMBER 2010

| CHC ARCHITECTURAL PLANS | |
|-------------------------|------------|
| <u>DRAWING</u> | <u>REV</u> |
| TP 01 | N |
| TP 02 | I |
| TP 03 | N |
| TP 04 | Q |
| TP 05 | Q |
| TP 06 | Q |
| TP 07 | N |
| TP 08 | Q |
| TP 09 | Q |
| TP 10 | Q |
| TP 11 | I |
| TP 12 | N |
| TP 13 | Q |
| TP 14 | C |
| TP 15 | C |
| TP 16 | C |
| TP 17 | O |
| TP 18 | O |
| TP 19 | A |
| TP 20 | A |
| TP 21 | A |
| TP 22 | A |
| TP 23 | A |

| CARDNO PLANS | |
|--------------|-----|
| TO 6 | P14 |
| TO 6 | P12 |
| TO 7 | P3 |
| TO 8 | P3 |
| TO 9 | P3 |
| TO 10 | P3 |
| SK 02 | |
| Sk 03 | |
| SK 20 | |
| SK 16 | |
| SK 17 | |
| SK 18 | |
| SK 19 | |

after David Ryner email to RTA of 20 October
as per RTA letter of 14 October & advertised

| LANDSCAPE PLAN | |
|----------------|---|
| L 01 | C |
| L 02 | C |
| L 03 | C |